

Bob Heyen Realty

235 19th St. P.O. Box 156
Hondo, TX 78861
Tel: (830) 426-4333
Fax: (830) 741-2080

Internet Address
www.bobheyenrealty.com
E-mail Address
bobheyenrealty@sbcglobal.net

- ACRES:** 3.593 acres, more or less.
- LOCATION:** 337 CR 2518
Moore, Texas 78057
- LEGAL:** All of Block 37 and Block 38 of the Speed Addition, Moore, Frio County, Texas.
- PRICE:** \$350,000.00.
- TERMS:** Cash to Seller or third-party financing.
- SCHOOL:** Pearsall I.S.D.
- TAXES:** 2023 taxes were approximately \$1,253.86 (with Homestead exemption).
- UTILITIES:** Reliant Energy is the electric provider, Moore Water Supply is the water provider, and the home is on public sewer system, not a septic system. Home is all electric.
- LAND:** The terrain is flat with elevation at approximately 640'. The entire property is cleared except for the perimeter which is lined with a variety of trees consisting of Oak, Mesquite, Elm and Hackberry and has barbed wire fencing on three sides. Moore Hollow runs along the eastern boundary. From the county road is a nice caliche driveway that leads up to the home. The immense outdoor space is a blank canvas with enough room around the home to grow and make your own!!
- IMPROVEMENTS:** A very nice 4BR/3B double wide home of approximately 1,792 sq. ft. (FCAD) of living area. The flooring consists of vinyl tile throughout for ease of maintenance. The island kitchen boasts a large walk-in pantry, butcherblock island with storage, and all appliances will convey including refrigerator, upright freezer, dishwasher, stove, microwave, as well as the washer and dryer. One living room has a built-in entertainment center along one wall and the secondary den area has a nice fireplace and built-in cabinets. Three bedrooms and two baths are on one end of the home with the primary bedroom and bath on the other. The primary bedroom has a walk-in closet and a

huge master bath with a soaking tub, separate shower, two separate vanities, and a skylight.

A sliding glass door off the dining area leads out to a spacious glass porch perfect for that morning cup of coffee or evening entertainment. Beyond the glass porch is a nice wood deck that overlooks the expansive backyard. Near the home metal barn of approximately 960 sq. ft. on a concrete slab. The front of the barn is used as a garage and the rear of the barn is a shop area with an enclosed room that would make a great office or flex space. There are two roll up doors and two single walk-thru doors in the barn. Behind the home is a dog kennel on a concrete slab as well as a nice metal RV canopy on a concrete slab. There are also two smaller storage buildings. Beyond the back yard is open space with plenty of room for expansion with the tree lined perimeter offering privacy.

REMARKS:

This turnkey, small acreage has everything you need to truly enjoy country living as well as room for a home-based business opportunity! Centrally located just off IH-35 makes for an easy commute to Pearsall, Yancey, Hondo, Devine, or San Antonio!!

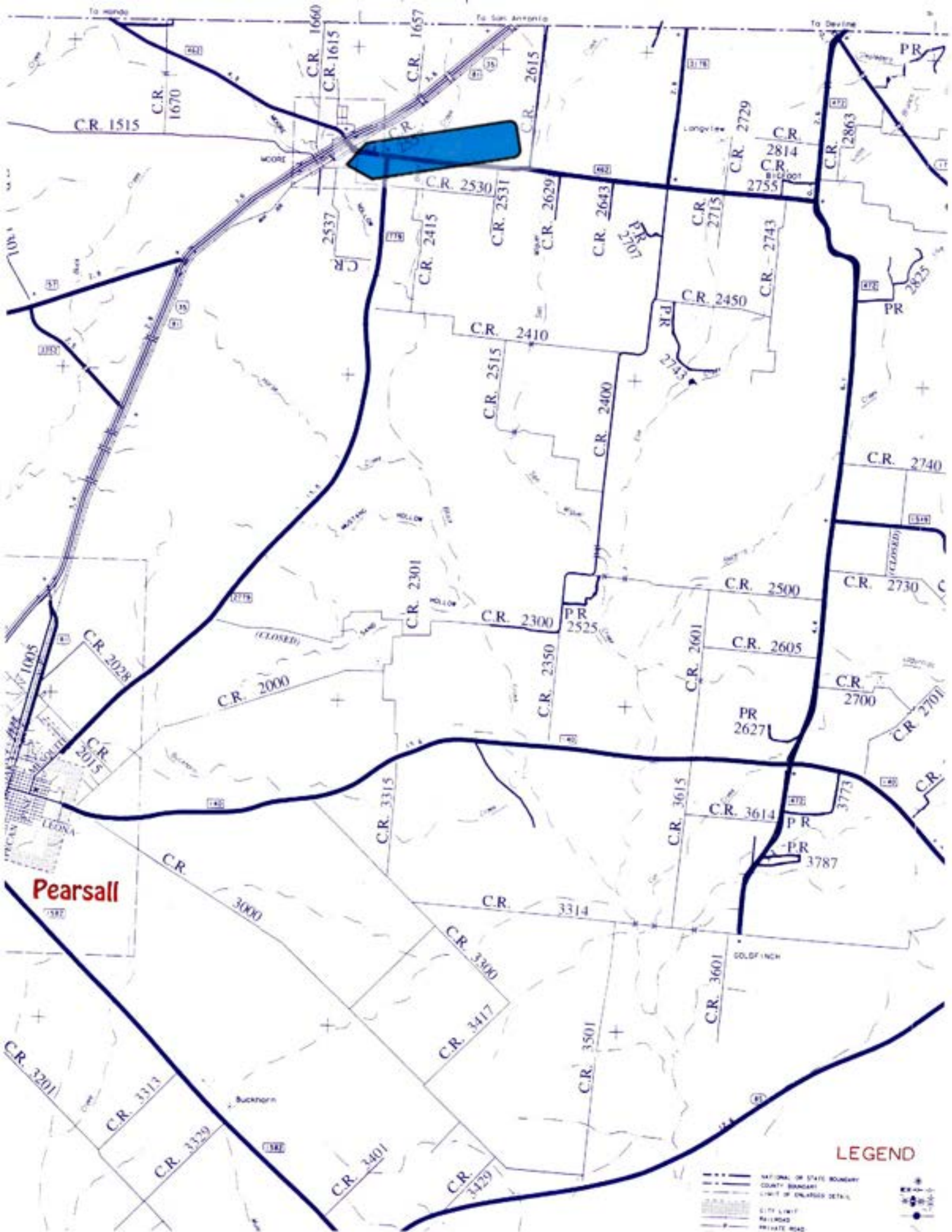

Pearsall

LEGEND

- NATIONAL OR STATE BOUNDARY
- COUNTY BOUNDARY
- CITY LIMIT
- RAILROAD
- PRIVATE ROAD

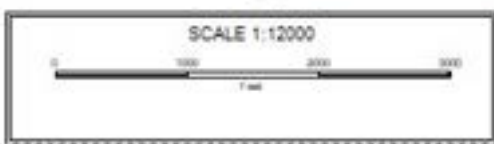
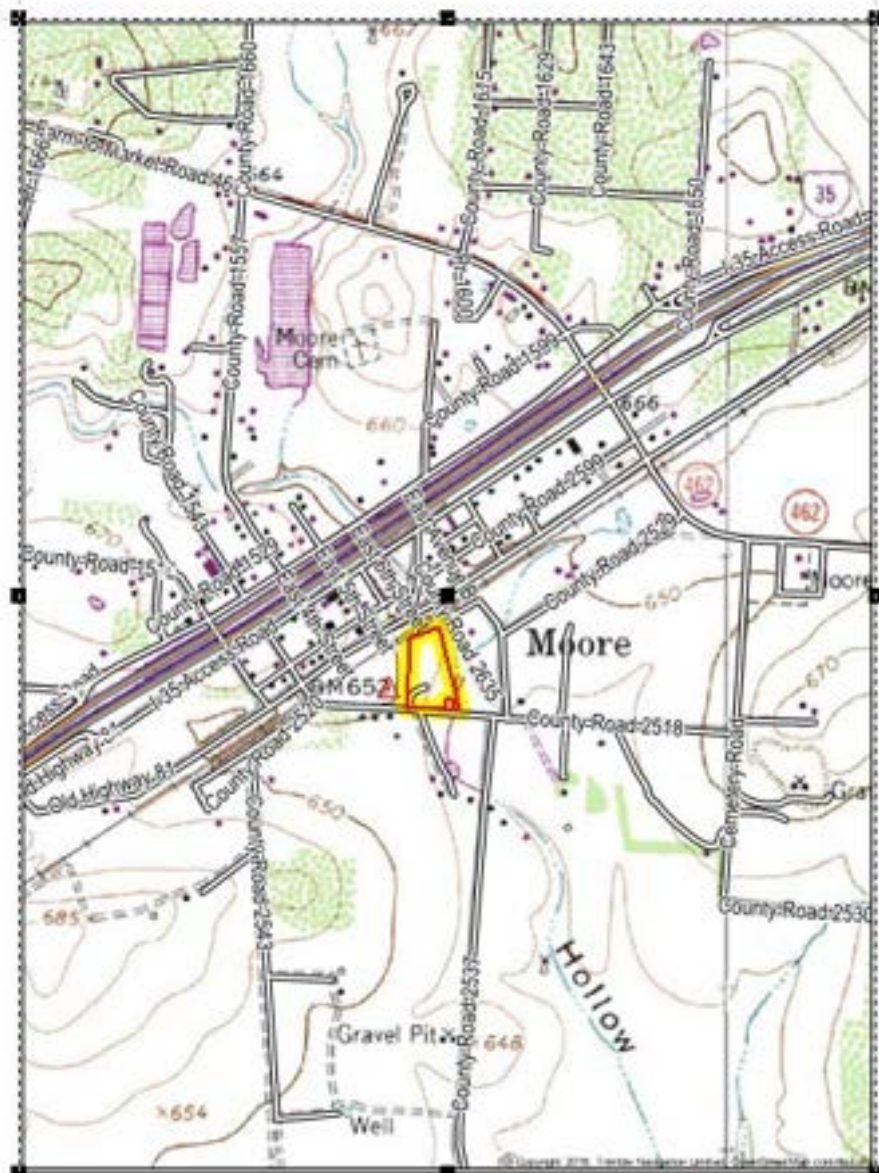

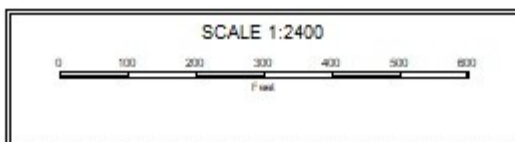



Concerning the Property at _____

Solar Panels	<input checked="" type="checkbox"/>	<input checked="" type="checkbox"/>	<input type="checkbox"/> owned <input type="checkbox"/> leased from: _____
Water Heater	<input checked="" type="checkbox"/>	<input type="checkbox"/>	<input checked="" type="checkbox"/> electric <input type="checkbox"/> gas <input type="checkbox"/> other: _____ number of units: <u>1</u>
Water Softener	<input checked="" type="checkbox"/>	<input type="checkbox"/>	<input checked="" type="checkbox"/> owned <input type="checkbox"/> leased from: _____
Other Leased Items(s)	<input type="checkbox"/>	<input checked="" type="checkbox"/>	if yes, describe: _____
Underground Lawn Sprinkler	<input type="checkbox"/>	<input checked="" type="checkbox"/>	<input type="checkbox"/> automatic <input type="checkbox"/> manual areas covered _____
Septic / On-Site Sewer Facility	<input type="checkbox"/>	<input checked="" type="checkbox"/>	if yes, attach Information About On-Site Sewer Facility (TXR-1407)

Water supply provided by: city well MUD co-op unknown other: _____

Was the Property built before 1978? yes no unknown

(If yes, complete, sign, and attach TXR-1906 concerning lead-based paint hazards).

Roof Type: Metal Age: 20 yrs (approximate)

Is there an overlay roof covering on the Property (shingles or roof covering placed over existing shingles or roof covering)? yes no unknown

Are you (Seller) aware of any of the items listed in this Section 1 that are not in working condition, that have defects, or are need of repair? yes no If yes, describe (attach additional sheets if necessary): _____

Section 2. Are you (Seller) aware of any defects or malfunctions in any of the following? (Mark Yes (Y) if you are aware and No (N) if you are not aware.)

Item	Y	N	Item	Y	N	Item	Y	N
Basement		<input checked="" type="checkbox"/>	Floors		<input checked="" type="checkbox"/>	Sidewalks		<input checked="" type="checkbox"/>
Ceilings		<input checked="" type="checkbox"/>	Foundation / Slab(s)		<input checked="" type="checkbox"/>	Walls / Fences		<input checked="" type="checkbox"/>
Doors		<input checked="" type="checkbox"/>	Interior Walls		<input checked="" type="checkbox"/>	Windows		<input checked="" type="checkbox"/>
Driveways		<input checked="" type="checkbox"/>	Lighting Fixtures		<input checked="" type="checkbox"/>	Other Structural Components		<input checked="" type="checkbox"/>
Electrical Systems		<input checked="" type="checkbox"/>	Plumbing Systems		<input checked="" type="checkbox"/>			
Exterior Walls		<input checked="" type="checkbox"/>	Roof		<input checked="" type="checkbox"/>			

If the answer to any of the items in Section 2 is yes, explain (attach additional sheets if necessary): _____

Section 3. Are you (Seller) aware of any of the following conditions? (Mark Yes (Y) if you are aware and No (N) if you are not aware.)

Condition	Y	N	Condition	Y	N
Aluminum Wiring		<input checked="" type="checkbox"/>	Radon Gas		<input checked="" type="checkbox"/>
Asbestos Components		<input checked="" type="checkbox"/>	Settling		<input checked="" type="checkbox"/>
Diseased Trees: <u>oak wilt</u>		<input checked="" type="checkbox"/>	Soil Movement		<input checked="" type="checkbox"/>
Endangered Species/Habitat on Property		<input checked="" type="checkbox"/>	Subsurface Structure or Pits		<input checked="" type="checkbox"/>
Fault Lines		<input checked="" type="checkbox"/>	Underground Storage Tanks		<input checked="" type="checkbox"/>
Hazardous or Toxic Waste		<input checked="" type="checkbox"/>	Unplatted Easements		<input checked="" type="checkbox"/>
Improper Drainage		<input checked="" type="checkbox"/>	Unrecorded Easements		<input checked="" type="checkbox"/>
Intermittent or Weather Springs		<input checked="" type="checkbox"/>	Urea-formaldehyde Insulation		<input checked="" type="checkbox"/>
Landfill		<input checked="" type="checkbox"/>	Water Damage Not Due to a Flood Event		<input checked="" type="checkbox"/>
Lead-Based Paint or Lead-Based Pt. Hazards		<input checked="" type="checkbox"/>	Wetlands on Property		<input checked="" type="checkbox"/>
Encroachments onto the Property		<input checked="" type="checkbox"/>	Wood Rot		<input checked="" type="checkbox"/>
Improvements encroaching on others' property		<input checked="" type="checkbox"/>	Active infestation of termites or other wood destroying insects (WDI)		<input checked="" type="checkbox"/>
Located in Historic District		<input checked="" type="checkbox"/>	Previous treatment for termites or WDI		<input checked="" type="checkbox"/>
Historic Property Designation		<input checked="" type="checkbox"/>	Previous termite or WDI damage repaired		<input checked="" type="checkbox"/>
Previous Foundation Repairs		<input checked="" type="checkbox"/>	Previous Fires		<input checked="" type="checkbox"/>

Concerning the Property at _____

Previous Roof Repairs	<input checked="" type="checkbox"/>
Previous Other Structural Repairs	<input checked="" type="checkbox"/>
Previous Use of Premises for Manufacture of Methamphetamine	<input checked="" type="checkbox"/>

Termite or WDI damage needing repair	<input checked="" type="checkbox"/>
Single Blockable Main Drain in Pool/Hot Tub/Spa*	<input checked="" type="checkbox"/>

If the answer to any of the items in Section 3 is yes, explain (attach additional sheets if necessary): _____

*A single blockable main drain may cause a suction entrapment hazard for an individual.

Section 4. Are you (Seller) aware of any item, equipment, or system in or on the Property that is in need of repair, which has not been previously disclosed in this notice? yes no If yes, explain (attach additional sheets if necessary): _____

Section 5. Are you (Seller) aware of any of the following conditions?* (Mark Yes (Y) if you are aware and check wholly or partly as applicable. Mark No (N) if you are not aware.)

- | | | |
|-------------------------------------|--------------------------|---|
| <u>Y</u> | <u>N</u> | |
| <input checked="" type="checkbox"/> | <input type="checkbox"/> | Present flood insurance coverage. |
| <input checked="" type="checkbox"/> | <input type="checkbox"/> | Previous flooding due to a failure or breach of a reservoir or a controlled or emergency release of water from a reservoir. |
| <input checked="" type="checkbox"/> | <input type="checkbox"/> | Previous flooding due to a natural flood event. |
| <input checked="" type="checkbox"/> | <input type="checkbox"/> | Previous water penetration into a structure on the Property due to a natural flood. |
| <input checked="" type="checkbox"/> | <input type="checkbox"/> | Located <input type="checkbox"/> wholly <input type="checkbox"/> partly in a 100-year floodplain (Special Flood Hazard Area-Zone A, V, A99, AE, AO, AH, VE, or AR). |
| <input checked="" type="checkbox"/> | <input type="checkbox"/> | Located <input type="checkbox"/> wholly <input type="checkbox"/> partly in a 500-year floodplain (Moderate Flood Hazard Area-Zone X (shaded)). |
| <input checked="" type="checkbox"/> | <input type="checkbox"/> | Located <input type="checkbox"/> wholly <input type="checkbox"/> partly in a floodway. |
| <input checked="" type="checkbox"/> | <input type="checkbox"/> | Located <input type="checkbox"/> wholly <input type="checkbox"/> partly in a flood pool. |
| <input checked="" type="checkbox"/> | <input type="checkbox"/> | Located <input type="checkbox"/> wholly <input type="checkbox"/> partly in a reservoir. |

If the answer to any of the above is yes, explain (attach additional sheets as necessary): (2015) water rose on rear of property, receded within a few hours.

***If Buyer is concerned about these matters, Buyer may consult Information About Flood Hazards (TXR 1414).**

For purposes of this notice:

"100-year floodplain" means any area of land that: (A) is identified on the flood insurance rate map as a special flood hazard area, which is designated as Zone A, V, A99, AE, AO, AH, VE, or AR on the map; (B) has a one percent annual chance of flooding, which is considered to be a high risk of flooding; and (C) may include a regulatory floodway, flood pool, or reservoir.

"500-year floodplain" means any area of land that: (A) is identified on the flood insurance rate map as a moderate flood hazard area, which is designated on the map as Zone X (shaded); and (B) has a two-tenths of one percent annual chance of flooding, which is considered to be a moderate risk of flooding.

"Flood pool" means the area adjacent to a reservoir that lies above the normal maximum operating level of the reservoir and that is subject to controlled inundation under the management of the United States Army Corps of Engineers.

Concerning the Property at _____

"Flood insurance rate map" means the most recent flood hazard map published by the Federal Emergency Management Agency under the National Flood Insurance Act of 1968 (42 U.S.C. Section 4001 et seq.).

"Floodway" means an area that is identified on the flood insurance rate map as a regulatory floodway, which includes the channel of a river or other watercourse and the adjacent land areas that must be reserved for the discharge of a base flood, also referred to as a 100-year flood, without cumulatively increasing the water surface elevation more than a designated height.

"Reservoir" means a water impoundment project operated by the United States Army Corps of Engineers that is intended to retain water or delay the runoff of water in a designated surface area of land.

Section 6. Have you (Seller) ever filed a claim for flood damage to the Property with any insurance provider, including the National Flood Insurance Program (NFIP)?* yes no If yes, explain (attach additional sheets as necessary): _____

*Homes in high risk flood zones with mortgages from federally regulated or insured lenders are required to have flood insurance. Even when not required, the Federal Emergency Management Agency (FEMA) encourages homeowners in high risk, moderate risk, and low risk flood zones to purchase flood insurance that covers the structure(s) and the personal property within the structure(s).

Section 7. Have you (Seller) ever received assistance from FEMA or the U.S. Small Business Administration (SBA) for flood damage to the Property? yes no If yes, explain (attach additional sheets as necessary): _____

Section 8. Are you (Seller) aware of any of the following? (Mark Yes (Y) if you are aware. Mark No (N) if you are not aware.)

Y N

Room additions, structural modifications, or other alterations or repairs made without necessary permits, with unresolved permits, or not in compliance with building codes in effect at the time.

Homeowners' associations or maintenance fees or assessments. If yes, complete the following:
Name of association: _____
Manager's name: _____ Phone: _____
Fees or assessments are: \$ _____ per _____ and are: mandatory voluntary
Any unpaid fees or assessment for the Property? yes (\$ _____) no
If the Property is in more than one association, provide information about the other associations below or attach information to this notice.

Any common area (facilities such as pools, tennis courts, walkways, or other) co-owned in undivided interest with others. If yes, complete the following:
Any optional user fees for common facilities charged? yes no If yes, describe: _____

Any notices of violations of deed restrictions or governmental ordinances affecting the condition or use of the Property.

Any lawsuits or other legal proceedings directly or indirectly affecting the Property. (Includes, but is not limited to: divorce, foreclosure, heirship, bankruptcy, and taxes.)

Any death on the Property except for those deaths caused by: natural causes, suicide, or accident unrelated to the condition of the Property.

Any condition on the Property which materially affects the health or safety of an individual.

Any repairs or treatments, other than routine maintenance, made to the Property to remediate environmental hazards such as asbestos, radon, lead-based paint, urea-formaldehyde, or mold.
If yes, attach any certificates or other documentation identifying the extent of the remediation (for example, certificate of mold remediation or other remediation).

Any rainwater harvesting system located on the Property that is larger than 500 gallons and that uses a public water supply as an auxiliary water source.

Concerning the Property at _____

- The Property is located in a propane gas system service area owned by a propane distribution system retailer.
- Any portion of the Property that is located in a groundwater conservation district or a subsidence district.

If the answer to any of the items in Section 8 is yes, explain (attach additional sheets if necessary): _____

Evergreen Underground Water Conservation District

Section 9. Within the last 4 years, have you (Seller) received any written inspection reports from persons who regularly provide inspections and who are either licensed as inspectors or otherwise permitted by law to perform inspections? yes no If yes, attach copies and complete the following:

Inspection Date	Type	Name of Inspector	No. of Pages

Note: A buyer should not rely on the above-cited reports as a reflection of the current condition of the Property. A buyer should obtain inspections from inspectors chosen by the buyer.

Section 10. Check any tax exemption(s) which you (Seller) currently claim for the Property:

- Homestead Senior Citizen Disabled
- Wildlife Management Agricultural Disabled Veteran
- Other: _____ Unknown

Section 11. Have you (Seller) ever filed a claim for damage, other than flood damage, to the Property with any insurance provider? yes no

Section 12. Have you (Seller) ever received proceeds for a claim for damage to the Property (for example, an insurance claim or a settlement or award in a legal proceeding) and not used the proceeds to make the repairs for which the claim was made? yes no If yes, explain: _____

Section 13. Does the Property have working smoke detectors installed in accordance with the smoke detector requirements of Chapter 766 of the Health and Safety Code?* unknown no yes. If no or unknown, explain. (Attach additional sheets if necessary): _____

**Chapter 766 of the Health and Safety Code requires one-family or two-family dwellings to have working smoke detectors installed in accordance with the requirements of the building code in effect in the area in which the dwelling is located, including performance, location, and power source requirements. If you do not know the building code requirements in effect in your area, you may check unknown above or contact your local building official for more information.*

A buyer may require a seller to install smoke detectors for the hearing impaired if: (1) the buyer or a member of the buyer's family who will reside in the dwelling is hearing-impaired; (2) the buyer gives the seller written evidence of the hearing impairment from a licensed physician; and (3) within 10 days after the effective date, the buyer makes a written request for the seller to install smoke detectors for the hearing-impaired and specifies the locations for installation. The parties may agree who will bear the cost of installing the smoke detectors and which brand of smoke detectors to install.

Concerning the Property at _____

Seller acknowledges that the statements in this notice are true to the best of Seller's belief and that no person, including the broker(s), has instructed or influenced Seller to provide inaccurate information or to omit any material information.

Joyanne True Bennett
Signature of Seller _____ Date _____ Signature of Seller _____ Date _____
Printed Name: Joyanne True Bennett Printed Name: _____

ADDITIONAL NOTICES TO BUYER:

- (1) The Texas Department of Public Safety maintains a database that the public may search, at no cost, to determine if registered sex offenders are located in certain zip code areas. To search the database, visit <https://publicsite.dps.texas.gov>. For information concerning past criminal activity in certain areas or neighborhoods, contact the local police department.
- (2) If the Property is located in a coastal area that is seaward of the Gulf Intracoastal Waterway or within 1,000 feet of the mean high tide bordering the Gulf of Mexico, the Property may be subject to the Open Beaches Act or the Dune Protection Act (Chapter 61 or 63, Natural Resources Code, respectively) and a beachfront construction certificate or dune protection permit may be required for repairs or improvements. Contact the local government with ordinance authority over construction adjacent to public beaches for more information.
- (3) If the Property is located in a seacoast territory of this state designated as a catastrophe area by the Commissioner of the Texas Department of Insurance, the Property may be subject to additional requirements to obtain or continue windstorm and hail insurance. A certificate of compliance may be required for repairs or improvements to the Property. For more information, please review *Information Regarding Windstorm and Hail Insurance for Certain Properties* (TXR 2518) and contact the Texas Department of Insurance or the Texas Windstorm Insurance Association.
- (4) This Property may be located near a military installation and may be affected by high noise or air installation compatible use zones or other operations. Information relating to high noise and compatible use zones is available in the most recent Air Installation Compatible Use Zone Study or Joint Land Use Study prepared for a military installation and may be accessed on the Internet website of the military installation and of the county and any municipality in which the military installation is located.
- (5) If you are basing your offers on square footage, measurements, or boundaries, you should have those items independently measured to verify any reported information.

(6) The following providers currently provide service to the Property:

Electric: <u>Reliant</u>	phone #: _____
Sewer: <u>Moore Water Supply</u>	phone #: _____
Water: <u>Moore Water Supply</u>	phone #: _____
Cable: <u>DISH</u>	phone #: _____
Trash: <u>C+C Garbage</u>	phone #: _____
Natural Gas: <u>N/A</u>	phone #: _____
Phone Company: _____	phone #: _____
Propane: <u>N/A</u>	phone #: _____
Internet: <u>AT&T</u>	phone #: _____

(TXR-1406) 07-10-23 Initialed by: Buyer: _____ and Seller: JTB _____ Page 6 of 7

Concerning the Property at _____

(7) This Seller's Disclosure Notice was completed by Seller as of the date signed. The brokers have relied on this notice as true and correct and have no reason to believe it to be false or inaccurate. YOU ARE ENCOURAGED TO HAVE AN INSPECTOR OF YOUR CHOICE INSPECT THE PROPERTY.

The undersigned Buyer acknowledges receipt of the foregoing notice.

Signature of Buyer	Date	Signature of Buyer	Date
Printed Name: _____		Printed Name: _____	



Information About Brokerage Services

Texas law requires all real estate licensees to give the following information about brokerage services to prospective buyers, tenants, sellers and landlords.

TYPES OF REAL ESTATE LICENSE HOLDERS:

- A **BROKER** is responsible for all brokerage activities, including acts performed by sales agents sponsored by the broker.
- A **SALES AGENT** must be sponsored by a broker and works with clients on behalf of the broker.

A BROKER'S MINIMUM DUTIES REQUIRED BY LAW (A client is the person or party that the broker represents):

- Put the interests of the client above all others, including the broker's own interests;
- Inform the client of any material information about the property or transaction received by the broker;
- Answer the client's questions and present any offer to or counter-offer from the client; and
- Treat all parties to a real estate transaction honestly and fairly.

A LICENSE HOLDER CAN REPRESENT A PARTY IN A REAL ESTATE TRANSACTION:

AS AGENT FOR OWNER (SELLER/LANDLORD): The broker becomes the property owner's agent through an agreement with the owner, usually in a written listing to sell or property management agreement. An owner's agent must perform the broker's minimum duties above and must inform the owner of any material information about the property or transaction known by the agent, including information disclosed to the agent or subagent by the buyer or buyer's agent.

AS AGENT FOR BUYER/TENANT: The broker becomes the buyer/tenant's agent by agreeing to represent the buyer, usually through a written representation agreement. A buyer's agent must perform the broker's minimum duties above and must inform the buyer of any material information about the property or transaction known by the agent, including information disclosed to the agent by the seller or seller's agent.

AS AGENT FOR BOTH - INTERMEDIARY: To act as an intermediary between the parties the broker must first obtain the written agreement of each party to the transaction. The written agreement must state who will pay the broker and, in conspicuous bold or underlined print, set forth the broker's obligations as an intermediary. A broker who acts as an intermediary:

- Must treat all parties to the transaction impartially and fairly;
- May, with the parties' written consent, appoint a different license holder associated with the broker to each party (owner and buyer) to communicate with, provide opinions and advice to, and carry out the instructions of each party to the transaction.
- Must not, unless specifically authorized in writing to do so by the party, disclose:
 - that the owner will accept a price less than the written asking price;
 - that the buyer/tenant will pay a price greater than the price submitted in a written offer; and
 - any confidential information or any other information that a party specifically instructs the broker in writing not to disclose, unless required to do so by law.

AS SUBAGENT: A license holder acts as a subagent when aiding a buyer in a transaction without an agreement to represent the buyer. A subagent can assist the buyer but does not represent the buyer and must place the interests of the owner first.

TO AVOID DISPUTES, ALL AGREEMENTS BETWEEN YOU AND A BROKER SHOULD BE IN WRITING AND CLEARLY ESTABLISH:

- The broker's duties and responsibilities to you, and your obligations under the representation agreement.
- Who will pay the broker for services provided to you, when payment will be made and how the payment will be calculated.

LICENSE HOLDER CONTACT INFORMATION: This notice is being provided for information purposes. It does not create an obligation for you to use the broker's services. Please acknowledge receipt of this notice below and retain a copy for your records.

Bob Heyen Realty Licensed Broker /Broker Firm Name or Primary Assumed Business Name	459073 License No.	bobheyenrealty@gmail.com Email	(830)426-4333 Phone
Kyle J. Heyen Designated Broker of Firm	459073 License No.	bobheyenrealty@gmail.com Email	(210)912-6007 Phone
Kyle J. Heyen Licensed Supervisor of Sales Agent/ Associate	459073 License No.	bobheyenrealty@gmail.com Email	(210)912-6007 Phone
Kimberly Heyen Sales Agent/Associate's Name	791205 License No.	bobheyenrealty@gmail.com Email	(830)931-5032 Phone

Buyer/Tenant/Seller/Landlord-Initials

Date

Regulated by the Texas Real Estate Commission
TXR-2501

Information available at www.trec.texas.gov
IABS 1-0 Date



Evergreen Underground Water Conservation District
110 Wyoming Blvd Pleasanton TX 78064
(830) 569-4186 email: info@evergreenuwcd.org

NOTICE TO PURCHASER OF REAL ESTATE
SITUATED IN EVERGREEN UNDERGROUND
WATER CONSERVATION DISTRICT

TO PURCHASER SHOWN BELOW:

The real property described below, which you are about to purchase, is located in the Evergreen Underground Water Conservation District (EUWCD); Atascosa, Wilson, Frio, and Karnes Counties, Texas. The District has taxing authority separate from any other taxing authority. The adopted tax rate for Tax Year 2024 is \$0.004890 per \$100.00 assessed valuation.

The purpose of the EUWCD is to conserve, preserve, protect, and recharge the groundwater resources of Atascosa, Wilson, Frio, and Karnes Counties, and to prevent waste and degradation of quality of those groundwater resources.

If an active or abandoned water well of any type is located on your property, you are required by EUWCD to register the well and/or transfer well ownership within forty five (45) days of the transfer of the property. Before any new well may be drilled or completed it must be registered with the EUWCD and receive specific authorization to commence drilling. Depending on the type of well, it is possible that the well will additionally require an operating permit, metering, and are subject to reporting requirements. Forms and information regarding this process can be found at <https://www.evergreenuwcd.org/permit-info>.

The undersigned purchaser hereby acknowledges receipt of the foregoing notice prior to closing of the purchase of the real property described in such notice.

The legal description of the property which you are acquiring is as follows:

EFFECTIVE DATE: _____.

[Remainder of page intentionally left blank; signatures are on the following pages]

EXECUTED this ____ day of _____, 2024, to be effective as of the Effective Date.

SELLER:

Seller

Seller

STATE OF TEXAS

COUNTY OF _____

Sworn to and subscribed before me on the ____ day of _____, 2024, by _____.

Notary Public Signature

BUYER:

Buyer

Buyer

STATE OF TEXAS

COUNTY OF _____

Sworn to and subscribed before me on the ____ day of _____, 2024, by _____.

Notary Public Signature

